

119 Purinton Road Brunswick, Maine 04011
Office/ Flex Space
Brunswick Landing



Property Highlights

Building Size: 10,000 sqft

Available Space: 5,535 sqft

Lease Rate: \$10.00 per sqft (NNN)

Parking: 40 spaces

Priority is pleased to offer 5,535 sqft of office/flex space for lease at Brunswick Landing. This space is ideal for a light industrial office user. The space offers 1 large conference room 2 private offices and 3 large open work areas.

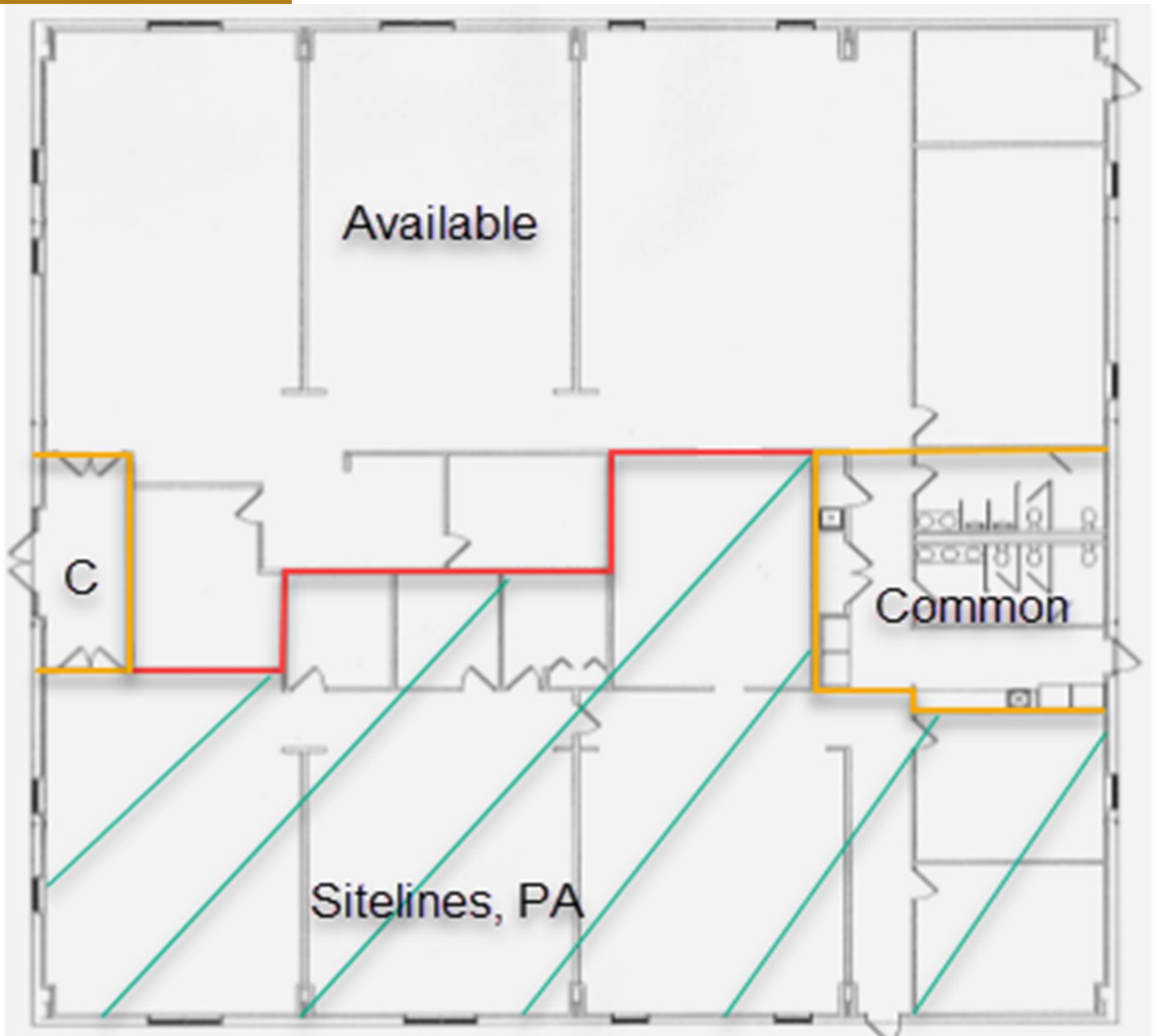

Property Details

Building Size: 10,000 sqft

Available Space: 5,535 sqft

Lease Rate: \$10.00 per sqft (NNN)

Annual Taxes: Pro-rata share

Annual Insurance: Pro-rate share

Water and Sewer: Municipal

Heat: Natural Gas, Central AC

Electrical: 400 amp 120/208V 3 phase

Sprinkled: Yes

Parking: 40 Spaces